

ELECTRICAL SCHEMATIC

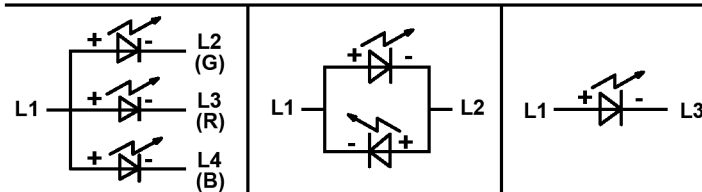
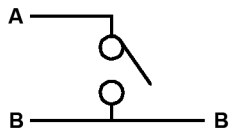

Compliance: RohS II (2011/65/EU)

Tolerances: ± 0.2 mm	Date	Name	<h1>TSLE 6868 R xyz</h1>
	04/19	dr	
			<h2>30 42 28</h2>
			Page 1/2
Modifications	Date	Name	knitter-switch

Specifications:

Contact rating: 50 mA, 12 V DC
Contact resistance: 100 mOhm max.
Insulation resistance: 100 MOhm min. at 250 V DC
Dielectric strength: 250 V AC (50/60 Hz) for 1 minute
Operating temperature: -40°C to +85°C
Storage temperature: -40°C to +85°C
Mechanical life: 300 000 cycles
Electrical life: 100 000 cycles
Operating force: 200 +/-50 gf
Travel: 0.70 +/-0.20 mm
Switch function: momentary; normally open
Soldering conditions: max.: 265°C, 5 sec.
pre-heat max.: 100°C, 60 sec.
Sealing: IP67
Material: Plunger: silicone
Cover: nickel-silver, thk. 0.20 mm
Contact: stainless steel, 0.5 µm silver plated
Base: PPA, white
Terminal: C2680, 1.5 µm silver plated

x, y, z	Color
R	red
Y	yellow
G	green
B	blue
W	white
P	pure green
A	amber
N	no LED

Excepted RGB, all combinations end with one or two „N“
 Example:
 RGB RGB-LED
 GNN one green LED
 WAN a white and an amber LED
 RYG not available, use RGB instead

P.C.B. LAYOUT
(TOP VIEW)

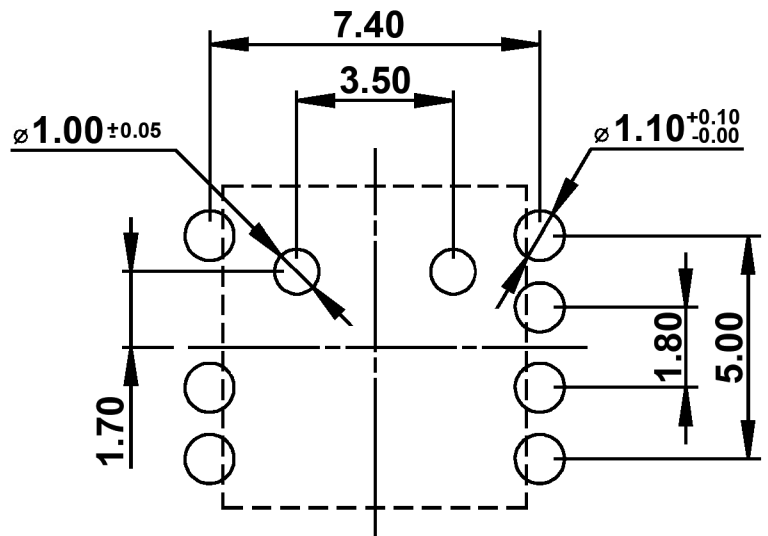

Compliance: RohS II (2011/65/EU)

Tolerances: ±0.2 mm	Date	Name	TSLE 6868 R xyz
	04/19	dr	
			30 42 28
			Page
			2/2
Modifications	Date	Name	